



**LINKK** Batten



# Batten Installation Guide

---



# LINK BATTEN INSTALLATION GUIDES

## LINK POWDER COATING

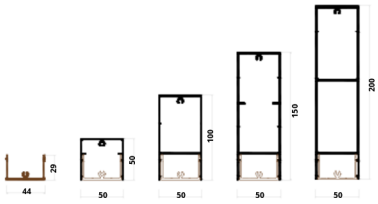

LDD 50 M Inner    LDD 9050 F Outer    LDD 10050 F Outer    LDD 15050 F Outer    LDD 20050 F Outer

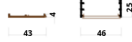

LDD 2546 M Inner    LDD 2546 F Outer



LDD 2538 M Inner    LDD 2538 F Outer

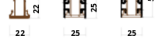

LDD 25 M Inner    LDD 2525 F Outer    LDD 5025 F Outer



LDD 7525 M Inner    LDD 7525 F Outer

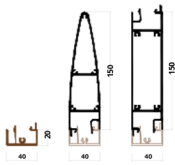

LDD 4020 M End    LDD 15040 Bull Nose    LDD 15040 Intermediate

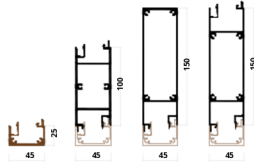

LDD 15045 F Blade    LDD 4520 M End    LDD 10045 F Intermediate Blade    LDD 15045 F Intermediate Blade

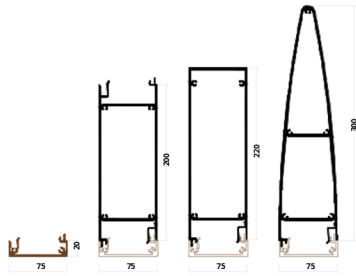

LDD 7520 M End    LDD 22075 F Blade    LDD 22075 F Blade    LDD 30075 F Bull Nose

# LINK BATTEN INSTALLATION GUIDES

## CELLING TO FLOOR MOUNTING BRACKETS

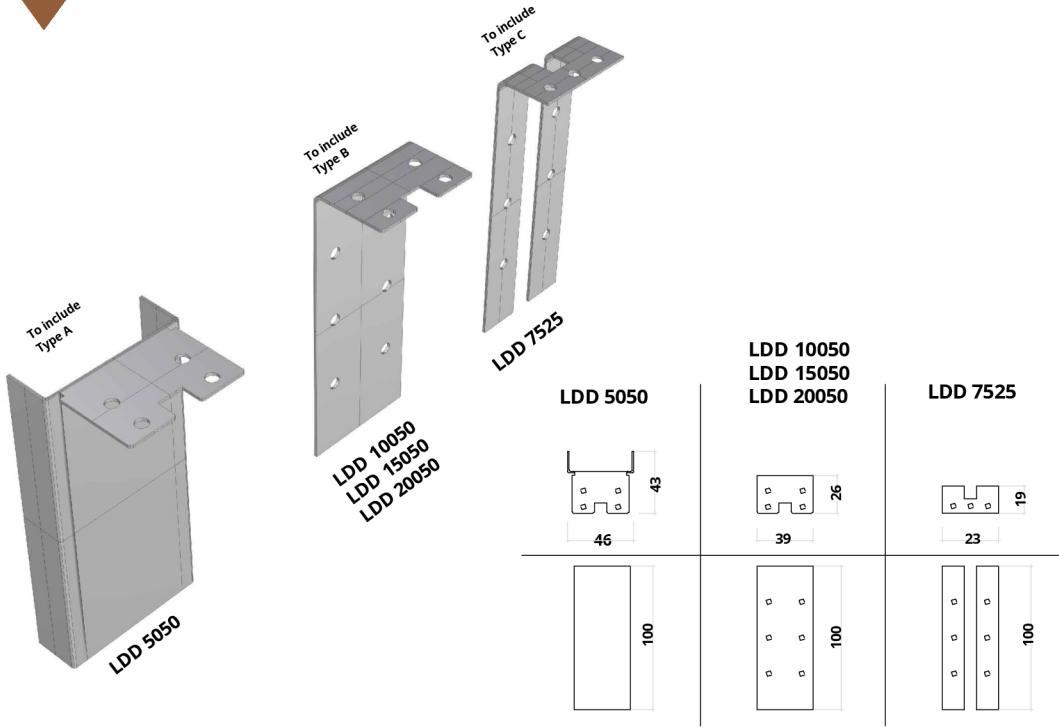

### Aluminum Endcaps

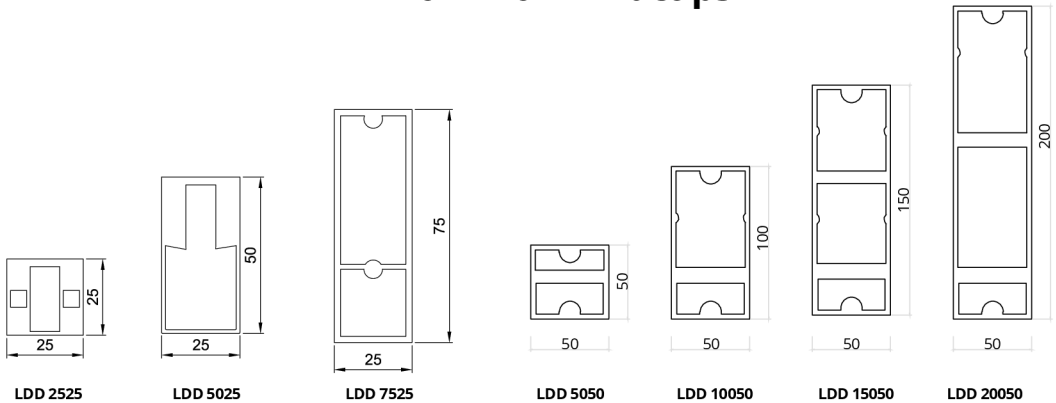

**Note :** Matching Aluminium end caps are offered to suit all batten shapes and sizes. The end caps are a press fit design.

Supply of end caps with counter sunk screw holes is optional.

### Useable sections

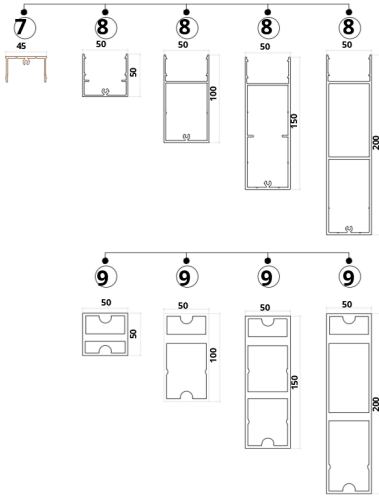

- 1- Wall (Exterior)
- 2- Sarking by others
- 3- Space
- 4- Batten or top hat
- 5- FC sheet
- 6- Paint
- 7- LDD 50 M Inner
- 8- LDD 50 F Series Battens
- 9- Endcap

### Top View

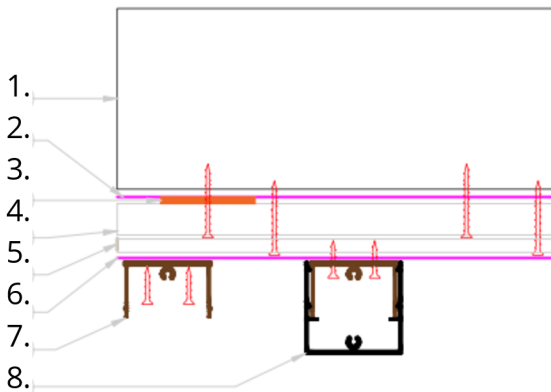

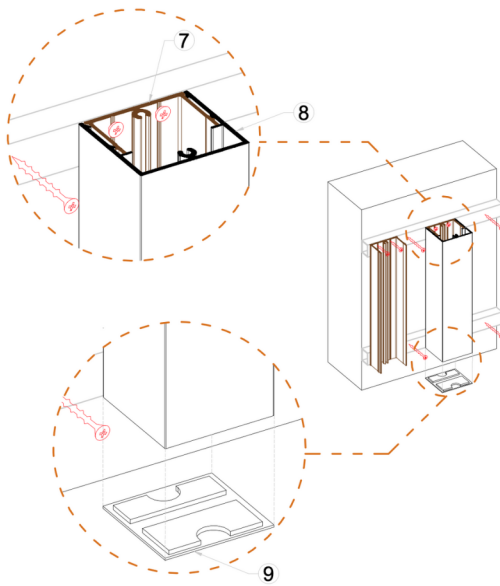

**Note : You can mix and match different sizes of the LDD F outer profile with each other.**

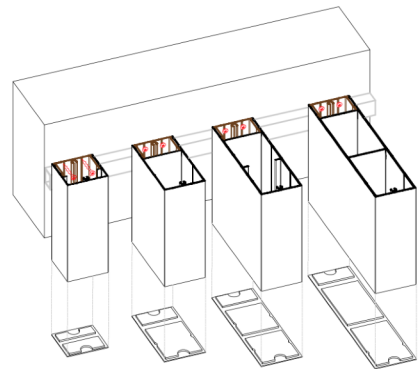

- 1- To make the wall waterproof, install sarking.
- 2- Install battens or top hat to the building structure, and level them with other installed battens.
- 3- Install FC sheets and then apply paint.
- 4- Install LDD 50 M inner profile. Screw its sides to the batten. The gap between them is a design decision.
- 5- After installing all the LDD 50 M inner profiles, install LDD 50 Series Outer Battens
- 6- Place end caps.

### Useable sections

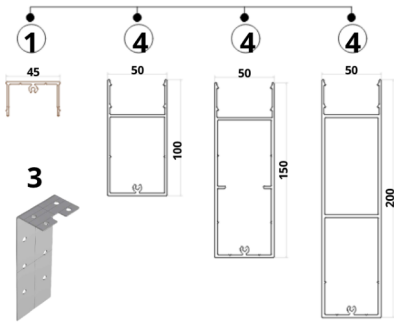

1- Fasten the mounting plate to both end of the LDD 10050 or LDD 15050 or LDD 20050 F Outer.

2- Screw the mounting brackets places to ceiling and floor.

3-Clip LDD 50 M Inner to F outer profiles.

- 1- LDD 50 M Inner
- 2- Screw
- 3- Mounting Brackets
- 4- LDD 10050 OR LDD 15050 OR LDD 20050
- 5- Ceiling
- 6- Floor

### Top View

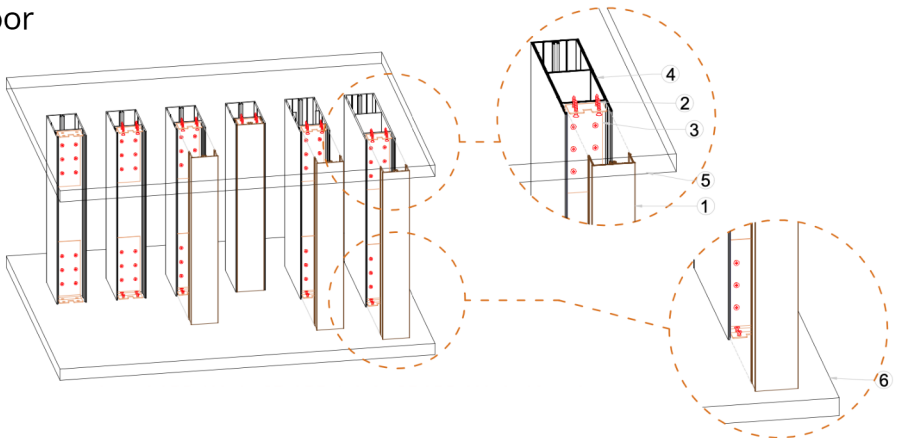
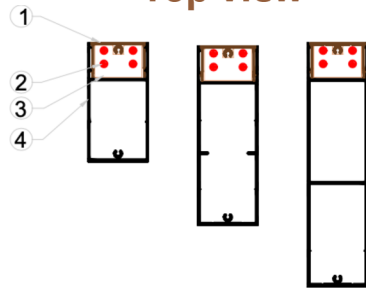

**Note :** You can mix and match LDD 10050 OR LDD 15050 OR LDD 20050 with each other. The gap between Battens is design decision.

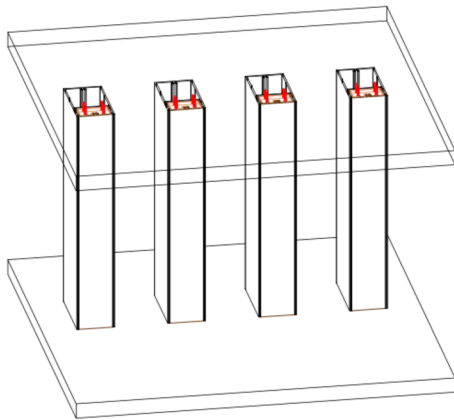

**Note : You can mix and match other.  
The gap between Battens is design decision.**

LDD 10050 OR LDD 15050 OR LDD 20050 Or with each

### Useable sections

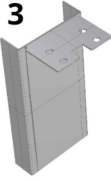
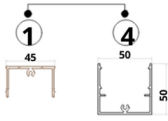

- 1- LDD 50 M Inner
- 2- Screw
- 3- Mounting plates
- 4- LDD 5050
- 5- Ceiling
- 6- Floor

- 1- Fasten the mounting plate to both end of the LDD 5050 F Outer.
- 2- Screw the mounting Brackets to ceiling and floor.
- 3- Clip LDD 50 M Inner to LDD 5050 F Outer profiles.

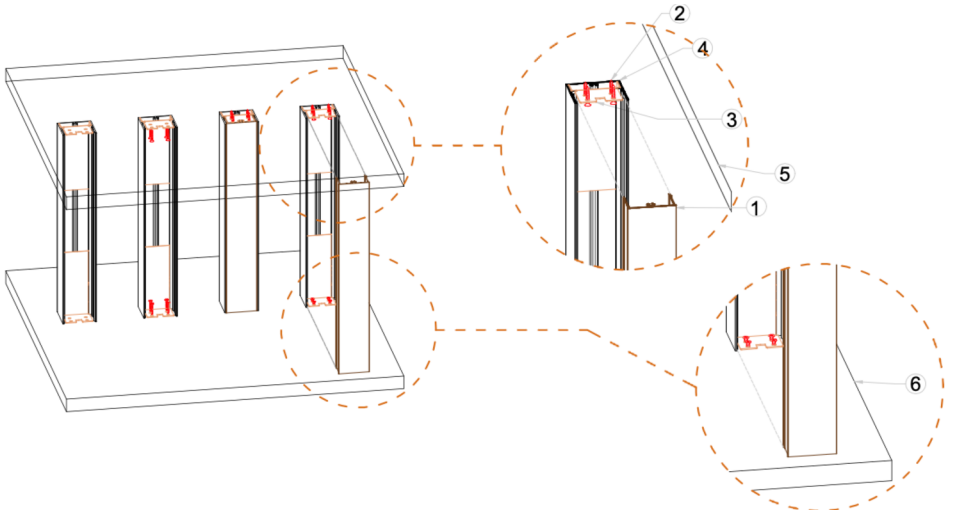
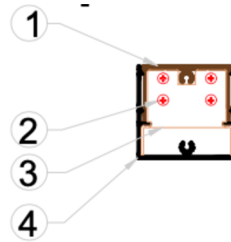

### Useable sections



- 1- Ceiling
- 2- Spacer
- 3- Batten or top hat
- 4- FC sheet OR  
Plaster board (Optional)
- 5- Paint (If you had layer4)
- 6- LDD 50 M Inner
- 7- LDD 50 F Series Battens
- 8- End Cap

### Front View

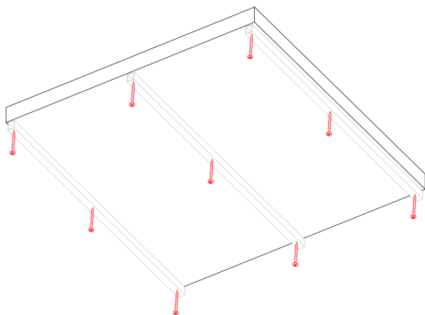
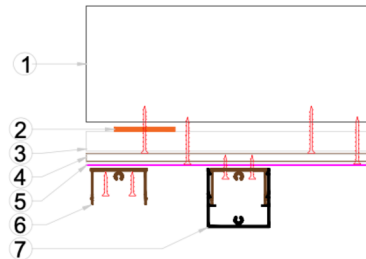

**1- Install battens or top hat to the Ceiling, and level them with other installed battens.**

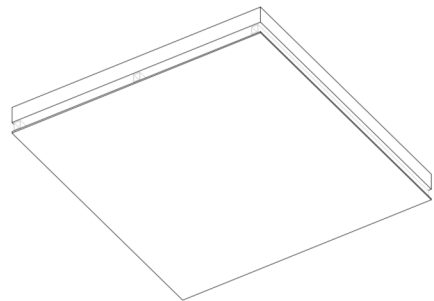

**2- Installing FC sheet or Plaster board is optional. If you installed then apply paint.**

### Useable sections

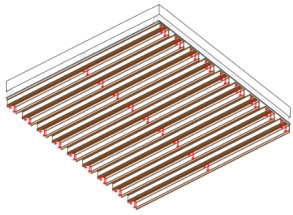

**3- Install LDD 50 M inner profile. Screw it to the batten. The gap between them is a design decision.**

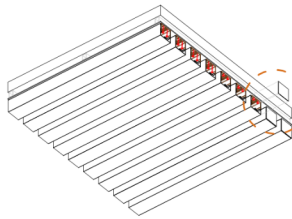

**5- After installing all the LDD 50 M inner profiles, clip LDD 5050 F outer.**  
**6- Place the end caps.**

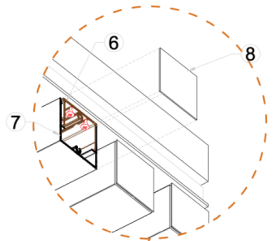

**Note : You can mix and match different sizes of the LDD F outer profile with each other. Sizes are:**

- LDD 5050 F Outer
- LDD 10050 F Outer
- LDD 15050 F Outer
- LDD 20050F Outer

### Useable sections

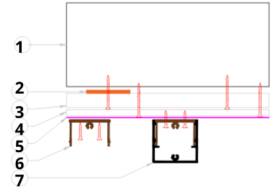
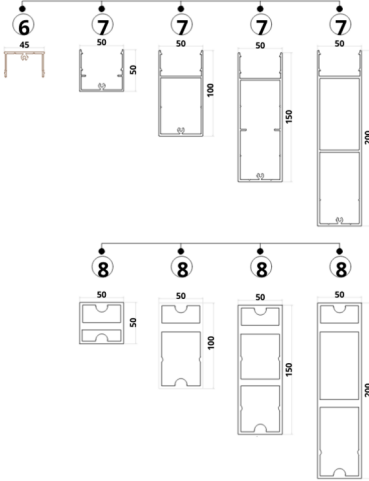

- 1- Wall
- 2- Spacer
- 3- Batten or Top hat
- 4- FC sheet OR  
Plaster board (Optional)
- 5- Paint (If you had layer4)
- 6- LDD 50 M Inner
- 7- LDD 50 F Series Battens
- 8- End Cap

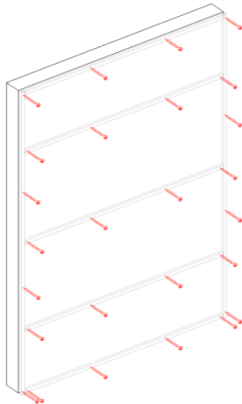

**1- Install battens or top hat to the Wall, and level them with other installed battens.**

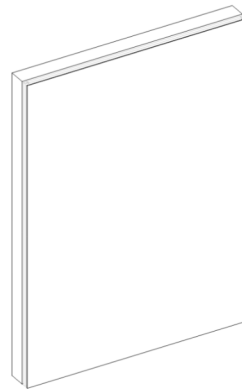

**2- Installing FC sheet or Plaster board is optional. If you installed then apply paint.**

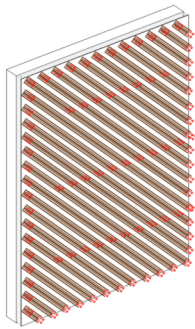

**3- Install LDD 50M inner profile in a desired angle. Screw it to the batten. The gap between battens and the angle are design decisions.**

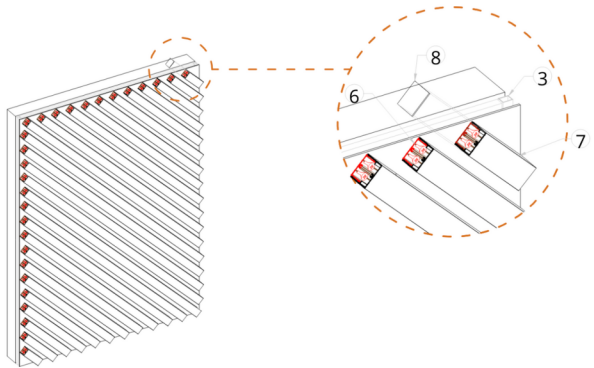

**5- After installing all the LDD 50 M inner profiles, clip LDD 5050 F outer.**

**6- Place the end caps.**

**Note : You can mix and match different sizes of the LDD F outer profile with each other.**

**Sizes are:** LDD 5050 F Outer  
LDD 10050 F  
Outer LDD 15050  
F Outer LDD  
20050F Outer

### Useable sections

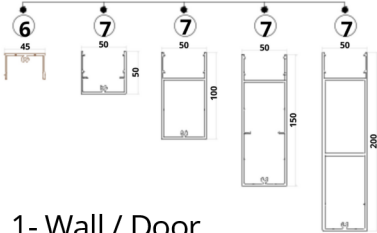

- 1- Wall / Door
- 2- Spacer
- 3- Batten or Top hat
- 4- FC sheet OR  
Plaster board (Optional)
- 5- Paint (If you had layer4)
- 6- LDD 50 M Inner
- 7- LDD 50 F Series Batten

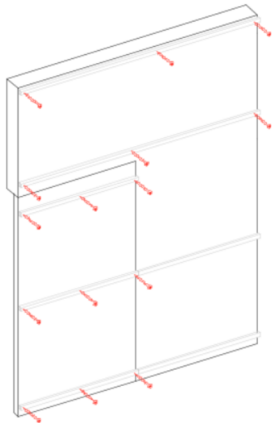
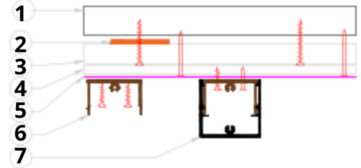

**1- Install battens or top hat to the Wall and door, and level them with other installed battens.**

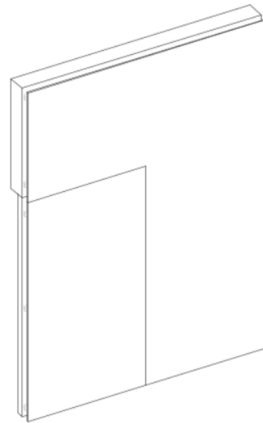

**2- Installing FC sheet or Plaster board is optional. If you installed then apply paint.**

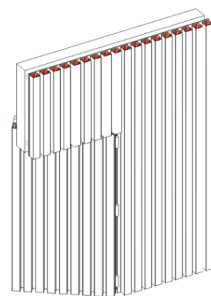
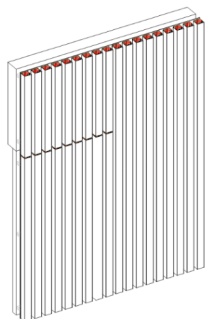
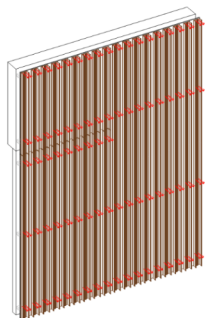

**3- Install LDD 50M inner profile.  
Screw it to the batten.  
The gap between battens is a design  
decision.**

**5- After installing all the LDD 50 M  
inner profiles, clip LDD 5050 F  
outer.**

**Note : You can mix and match  
different sizes of  
the LDD F outer profile with each  
other.**

**Sizes are:** LDD 5050 F Outer  
LDD 10050 F  
Outer LDD 15050  
F Outer LDD  
20050F Outer

### Useable sections

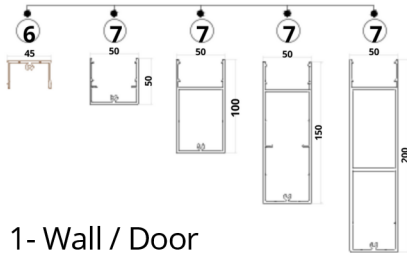

- 1- Wall / Door
- 2- Spacer
- 3- Batten or Top hat
- 4- FC sheet OR  
Plaster board (Optional)
- 5- Paint (If you had layer4)
- 6- LDD 50 M Inner
- 7- LDD 50 F Series Batten

### Top View

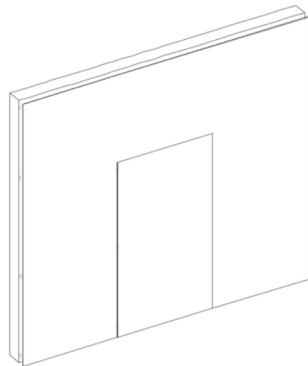
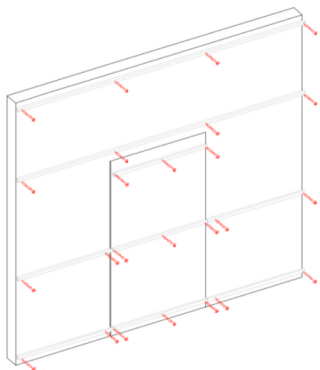
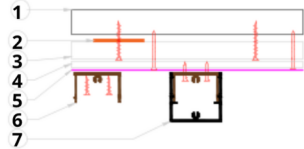
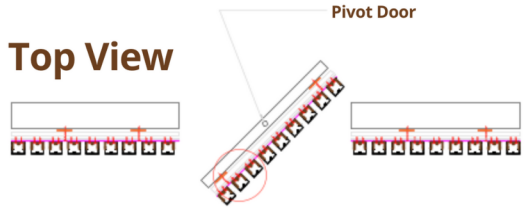

**1- Install battens or top hat to the Wall and door, and level them with other installed battens.**

**2- Installing FC sheet or Plaster board is optional. If you installed then apply paint.**

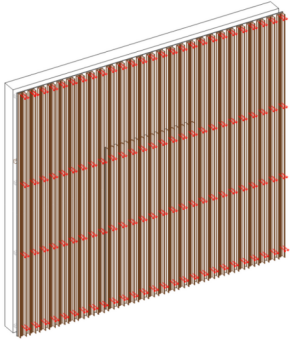

**3- Install LDD 50M inner profile. Screw it to the batten. The gap between battens is a design decision.**

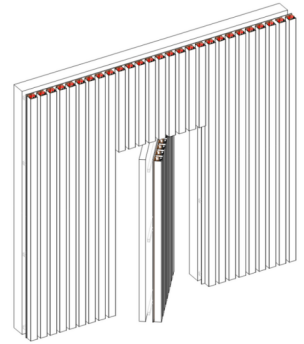
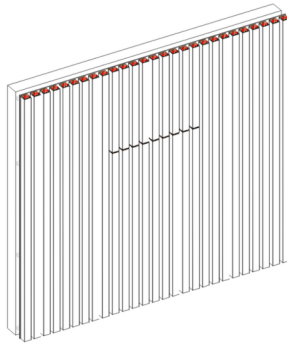

**5- After installing all the LDD 50 M inner profiles, clip LDD 5050 F outer.**

**Note : You can mix and match different sizes of the LDD F outer profile with each other.**

**Sizes are:** LDD 5050 F Outer  
LDD 10050 F Outer  
LDD 15050 F Outer  
LDD 20050F Outer

### Useable sections

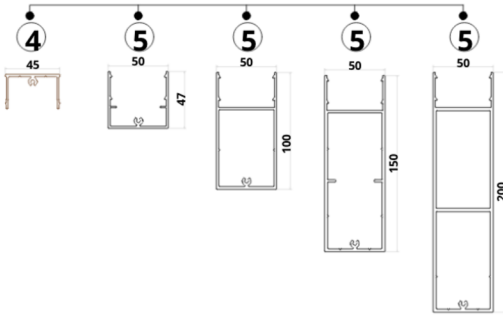

- 1- Wall
- 2- Spacer
- 3- Batten or Top hat
- 4- LDD 50 M Inner
- 5- LDD 50 F Series Batten

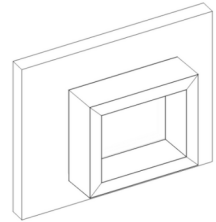
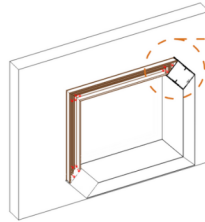
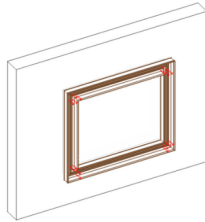
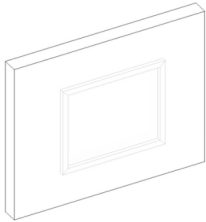
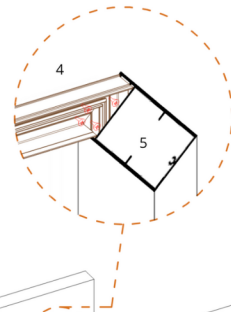

1- Install battens or top hat around the opening. both end of the batten have to be cut in 45 degree angle. level battens with other installed battens.

2- Install LDD 50M inner profile. Screw it to the batten, both end of the profile have to be cut in 45 degree angle to shape the opening.

3- Clip LDD 15050 F outer, both end of the profile have to be cut in 45 degree angle to shape the opening.

**Note: You can also make Windows sunshades out of**

LDD 10050

LDD 15050

LDD 20050

### Useable sections

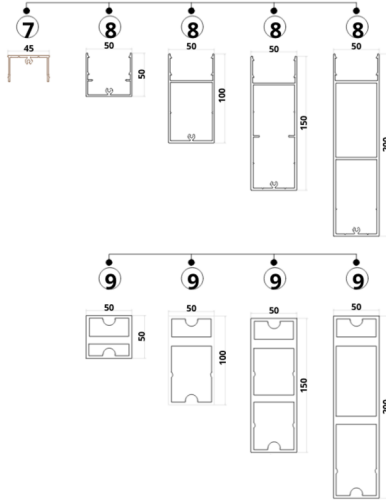

- 1- Ceiling
- 2- Hanger
- 3- Batten or Top hat
- 4-Batten or Top hat
- 5-Plaster board
- 6- Paint
- 7- LDD 50 M Inner
- 8- LDD 10050 F Outer
- 9- End Caps

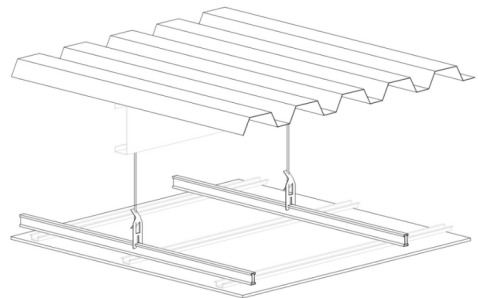
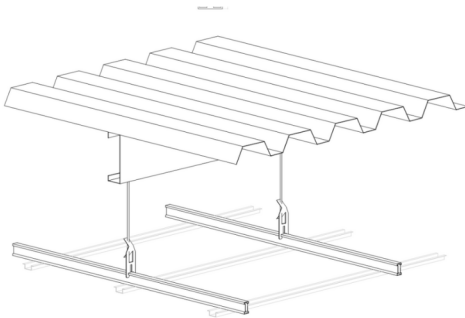
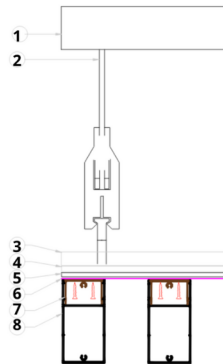

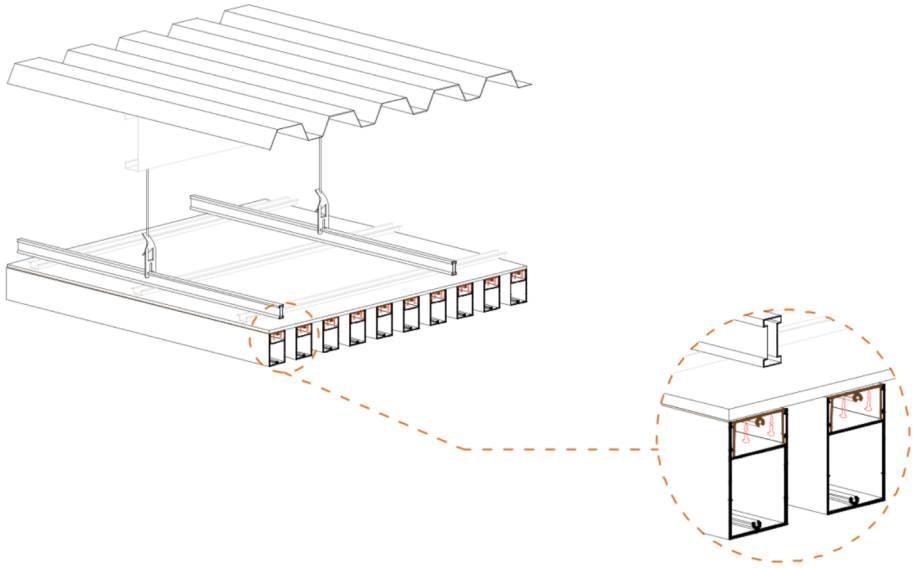



**Note: 50 M Inner installed in 100mm pieces in desired lines of battens for the easement of interrelation of the Female battens**



**Leading Providers of Woodgrain Sublimation and Powder Coating Services in Australia.**

 02 9622 6205

 02 9622 6242

 [Sales@linkpowdercoating.com.au](mailto:Sales@linkpowdercoating.com.au)

 6-8 Garling Road, Kings Park, NSW 2148

 10 Valediction Road, Kings Park, NSW 2148

 /linkpowdercoating

 /linkpowdercoating